



JDA WONDERLAND PARK, JAIPUR

Technical Specifications

General

ID	: 4092 (Sym) / 4093 (Asy)
System Wattage	: 3W LED
Driver Integral	: Constant Current
Operating Voltage	: 150-270Vac
Operating Temperature	: -15°C~+50°C

Physical

Body	: Die-Cast Aluminium
Front Ring	: 316 Grade Stainless Steel
Diffuser	: Clear Toughened Glass
Mounting Sleeve	: Polypropylene Black
Mounting	: Recess

Light Source

Light Source	: NICHIA
CRI (Ra)	: ≥80
LED Colour Temperature	: 2700K / 3000K / 4000K / 5700K

Driver

Input Voltage	: 240Vac
Frequency	: 50-60 Hz

Optical Performance

Beam Angle (Sym)	: 8°/12°/24°/40°/60°/40°x11°
------------------	------------------------------



Symmetrical



Asymmetrical

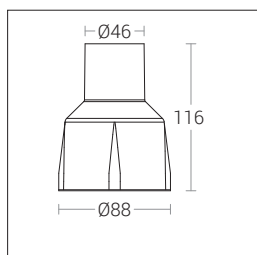
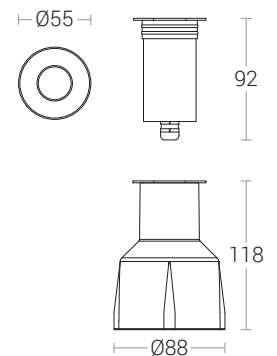

Note : It is our constant endeavor to upgrade the performance of our products. For the latest technical information, IES files and product updates please refer to the website at www.klite.in



JDA WONDERLAND PARK, JAIPUR



Symmetrical



Asymmetrical

Technical Specifications

General

ID	: 4092 (Sym) / 4093 (Asy)
System Wattage	: 3W LED
Driver Non-Integral	: Constant Voltage
Operating Voltage	: 24Vdc
Operating Temperature	: -15°C~+50°C

Physical

Body	: Die-Cast Aluminium
Front Ring	: 316 Grade Stainless Steel
Diffuser	: Clear Toughened Glass
Mounting Sleeve	: Polypropylene Black
Mounting	: Recess

Light Source

Light Source	: NICHIA
CRI (Ra)	: ≥80
LED Colour Temperature	: 2700K / 3000K / 4000K / 5700K

Driver

Power Supply	: Non Integral
--------------	----------------

Optical Performance

Beam Angle (Sym)	: 8°/12°/24°/40°/60°/40°x11°
------------------	------------------------------

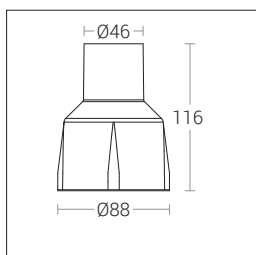
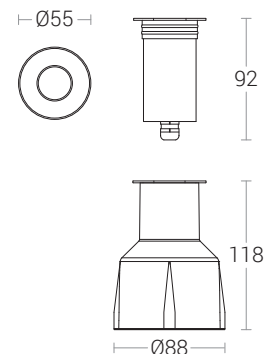

Note : It is our constant endeavor to upgrade the performance of our products. For the latest technical information, IES files and product updates please refer to the website at www.klite.in