

These energy efficient In-ground recessed luminaire's are designed to create luminous walkways or accentuate architecture elements in facades and landscapes providing distinctive lighting effects. Designed for high lumen efficiency at reduced wattage creating exceptional lighting effects.

Product Description

- Luminaire housing made up of pressure die-cast aluminium of high corrosion resistance and non corrosive stainless steel fasteners.
- Hard chromeplated stainless steel 316 grade front ring.
- Silicone seal gasket.
- Clear toughened glass.
- Luminaire hard wired with 3 x 0.5mm² cable of 0.5 metre length.
- Supplied with mounting sleeve for preparing recessed opening in ground or wall.
- Cable entries for through-wiring of mains supply cable.
- Integral constant current power supply
- CRI (Ra) : ≥80
- Prewired with LED driver and suitable for operating on 240V, 50Hz single phase ac supply.
- Ordering guide : KL-4092-CCT (Colour Temperature)
- Available CCT : 2700K, 3000K, 4000K, 5700K



Product Benefits

- High luminous efficiency at reduced wattage.
- A sleek and minimalist shape provides distinctive lighting effects for inground and wall architecture.
- Sustainable LED technology offers durability and optimal light output with low power consumption.

Area of Application

Walk ways, Facades, Landscapes, Architectural elements.

Accessory

- Supplied with IP67 rated connector for a secure connection to the network.
- Polypropylene mounting sleeve for easy installation.

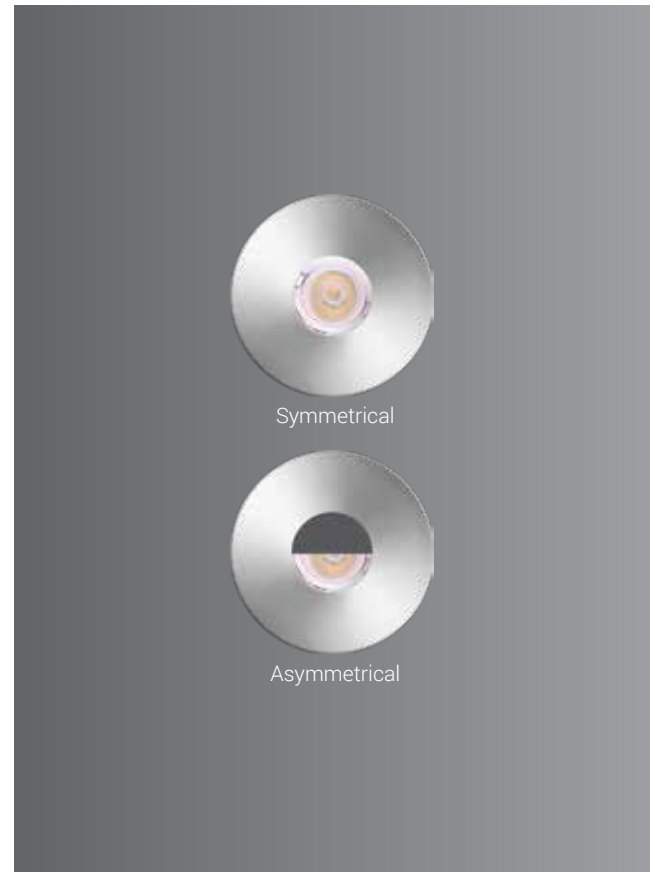



JDA WONDERLAND PARK, JAIPUR



Symmetrical



Asymmetrical

Technical Specifications

General

ID : 4092 (Sym) / 4093 (Asy)
 System Wattage : 3W LED
 Driver Integral : Constant Current
 Operating Voltage : 150-270Vac
 Operating Temperature : -15°C~+50°C

Light Source

Light Source : NICHIA
 CRI (Ra) : ≥80
 LED Colour Temperature : 2700K / 3000K / 4000K / 5700K

Physical

Body : Die-Cast Aluminium
 Front Ring : 316 Grade Stainless Steel
 Diffuser : Clear Toughened Glass
 Mounting Sleeve : Polypropylene Black
 Mounting : Recess

Driver

Input Voltage : 240Vac
 Frequency : 50-60 Hz

Optical Performance

Beam Angle (Sym) : 8°/12°/24°/40°/60°/40°x11°

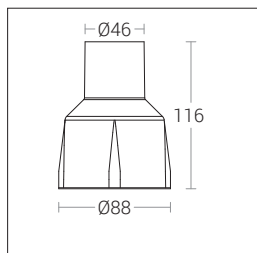
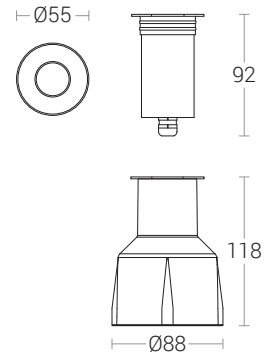

Note : It is our constant endeavor to upgrade the performance of our products. For the latest technical information, IES files and product updates please refer to the website at www.klite.in

These energy efficient In-ground recessed luminaire's are designed to create luminous walkways or accentuate architecture elements in facades and landscapes providing distinctive lighting effects. Designed for high lumen efficiency at reduced wattage creating exceptional lighting effects.

Product Description

- Luminaire housing made up of pressure die-cast aluminium of high corrosion resistance and non corrosive stainless steel fasteners.
- Hard chromeplated stainless steel 316 grade front ring.
- Silicone seal gasket.
- Clear toughened glass.
- Luminaire hard wired with 3 x 0.5mm² cable of 0.5 metre length.
- Supplied with mounting sleeve for preparing recessed opening in ground or wall.
- Cable entries for through-wiring of mains supply cable.
- CRI (Ra) : ≥80
- Constant voltage non integral power supply
- Low Voltage at 24Vdc assures safety.
- Ordering guide : KL-4092-CCT (Colour Temperature)
- Available CCT : 2700K, 3000K, 4000K, 5700K



Product Benefits

- High luminous efficiency at reduced wattage.
- A sleek and minimalist shape provides distinctive lighting effects for inground and wall architecture.
- Sustainable LED technology offers durability and optimal light output with low power consumption.

Area of Application

Walk ways, Facades, Landscapes, Architectural elements.

Accessory

- Supplied with IP67 rated connector for a secure connection to the network.
- Polypropylene mounting sleeve for easy installation.

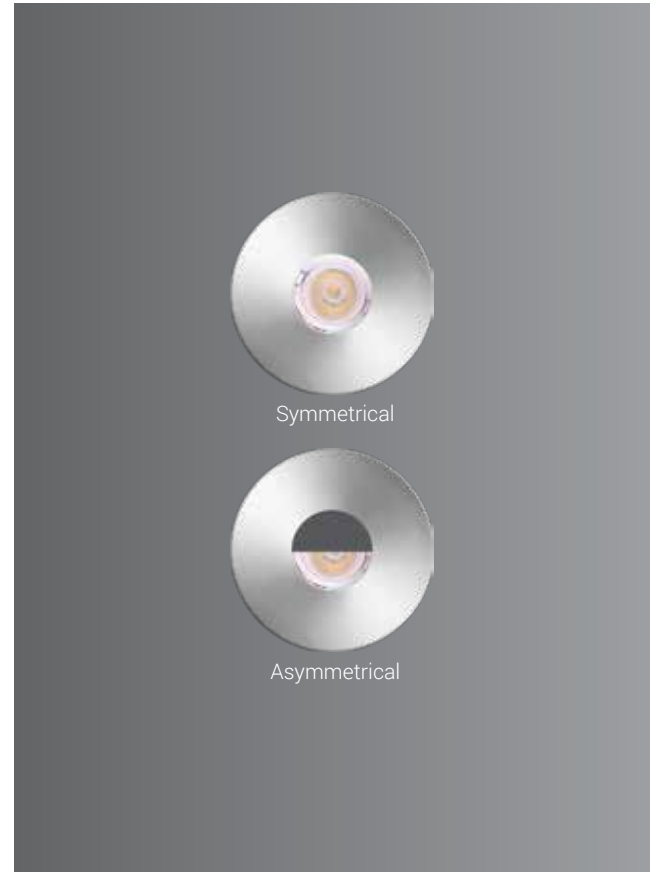



JDA WONDERLAND PARK, JAIPUR



Symmetrical



Asymmetrical

Technical Specifications

General

ID : 4092 (Sym) / 4093 (Asy)
 System Wattage : 3W LED
 Driver Non-Integral : Constant Voltage
 Operating Voltage : 24Vdc
 Operating Temperature : -15°C~+50°C

Light Source

Light Source : NICHIA
 CRI (Ra) : ≥80
 LED Colour Temperature : 2700K / 3000K / 4000K / 5700K

Physical

Body : Die-Cast Aluminium
 Front Ring : 316 Grade Stainless Steel
 Diffuser : Clear Toughened Glass
 Mounting Sleeve : Polypropylene Black
 Mounting : Recess

Driver

Power Supply : Non Integral

Optical Performance

Beam Angle (Sym) : 8°/12°/24°/40°/60°/40°x11°

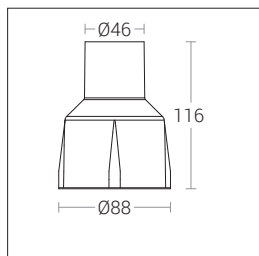
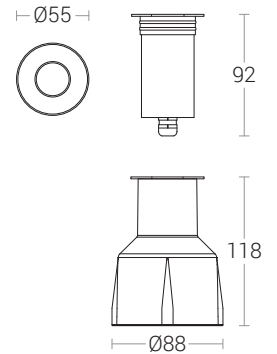

Note : It is our constant endeavor to upgrade the performance of our products. For the latest technical information, IES files and product updates please refer to the website at www.klite.in