

Surface mounted range of wall lights are a perfect fit for varied outdoor lighting applications. Designed to illuminate the wall and surface in front of wall and for light accents on vertical surfaces. Aesthetically designed sturdy construction ensures a long life against all weather condition, maintaining initial performances through the lifetime of the installation.

Product Description

- Lamp compartment encased in single moulded spherical Clear PMMA diffuser, moisture proof and insect free.
- Turn type polycarbonate locking system for easy maintenance.
- Polycarbonate base for mounting.
- Surface mounting on wall using hardware after connecting to the power supply.
- Cable entries for through-wiring of mains supply cable
- Prewired with E27 holder and suitable for operation on 240V, 50Hz single phase ac supply.



Product Benefits

- Elegance, Functionality.
- Moisture proof, insect free.
- The diffuser contributes to the creation of ambiance and to visual comfort by reducing glare.
- Low maintenance cost.

Area of Application

Lobbies & Foyers, Retail Sector, Internal passages, commercial complex, Pathways in residential buildings & office complex.

Available Finish

Pure polyester powder coated

- Graphite grey
- Anthracite grey
- Jet black

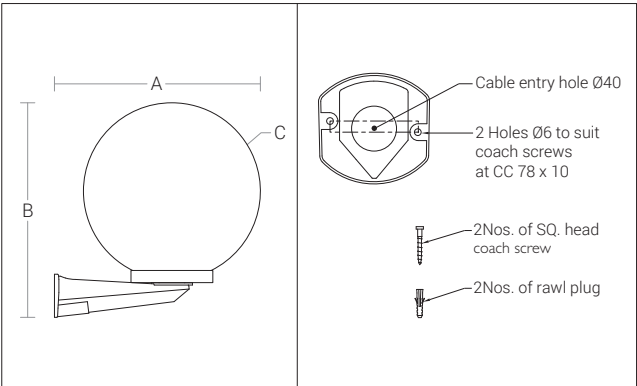

ID	Holder	A	B	C
4907	E27	465	485	Ø400

Max. Wattage E27 : 30W LED / 45W CFLE