

1

IF IN DOUBT ASK. DO NOT SCALE.

3

4

DWG. CODE : KP-DFD-091  
SHEET No. : 1 of 1

ALL DIMENSIONS ARE IN mm

Foundation height

Foundation type	POLE HEIGHT	DIMENSION "X"
"A"	8'	500
"B"	3m - 14'	600

With Base cover & without Base cover option

Foundation type	Horizontal level finished "Y"	Coarse sand "Z"
"C" Without base cover	□300	□400
"D" With base cover	□400	□500

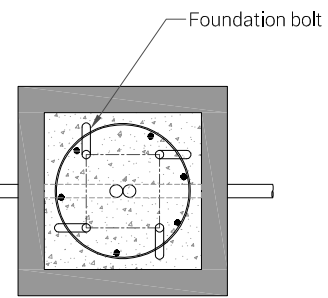
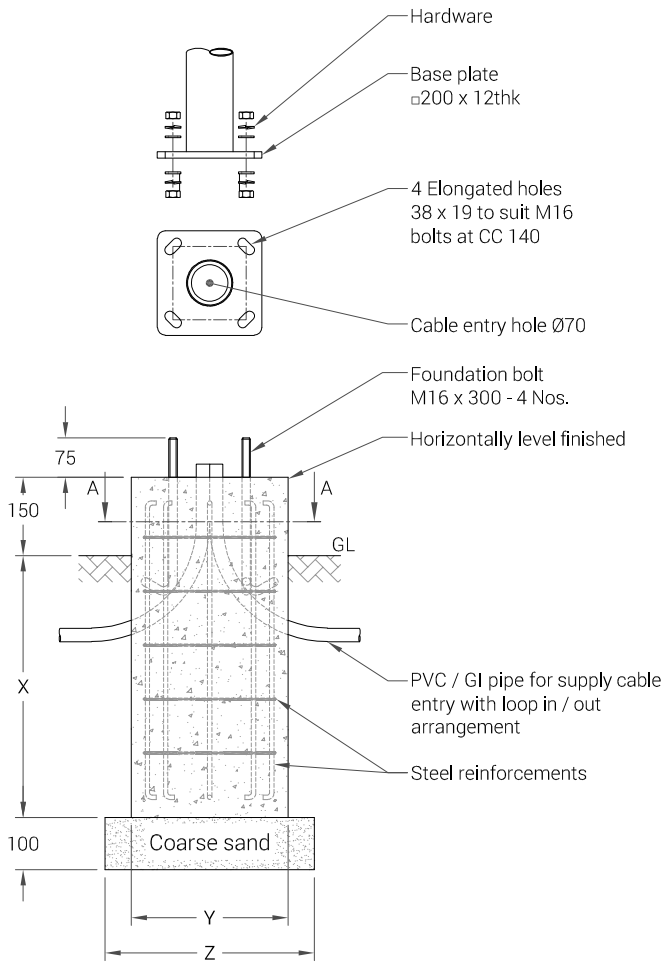

Section: A - A

Note :

- Typical foundation drawing. Contact local site engineer for detailed drawing
- Parameters considered in RCC foundation design :  
Load bearing capacity of soil (LBC) : 10 Mt/m<sup>2</sup> (Minimum)  
Grade of steel reinforcement : Fe 415  
Grade of foundation bolt : 4.6
- Height of foundation above ground level (150mm) may be revised to suit the site conditions especially considering the expected water level stagnation.
- Template supplied is suggested to be used for locating the CC of foundation bolts.
- 4 Nos. of foundation bolts have to be oriented (located), while casting the foundation such that the door of the electrical junction box faces the required direction.
- PVC / GI pipe for entry of supply cable and the materials required for foundation are not scope of our supply.

01.	DESIGN REVISED	14-11-24	SANKAR		
REV. No.	REVISION DETAILS	DATE	REVISED	CHD	APPD

DRAWN BASKAR	CHECKED	APPROVED	DATE 28-05-18	SCALE 1 : 15	MATERIAL -
-----------------	---------	----------	------------------	-----------------	---------------

Y:\KP\005.FOUNDATION DETAILS\KP-DFD-091 (KP-44)\KP-DFD-091 (KP-44), REV 01.dwg

**K-LITE**

**K-LITE INDUSTRIES  
PRIVATE LIMITED**  
CHENNAI-600 058

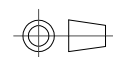

DRG. CODE.  
**KP-DFD-091**

REV  
01

SHEET  
1 of 1

1

2

3

4