

1

2 IF IN DOUBT ASK. DO NOT SCALE.

3

4

DWG. No. : KL-DFD-103  
SHEET No. : 1 of 1

ALL DIMENSIONS ARE IN mm

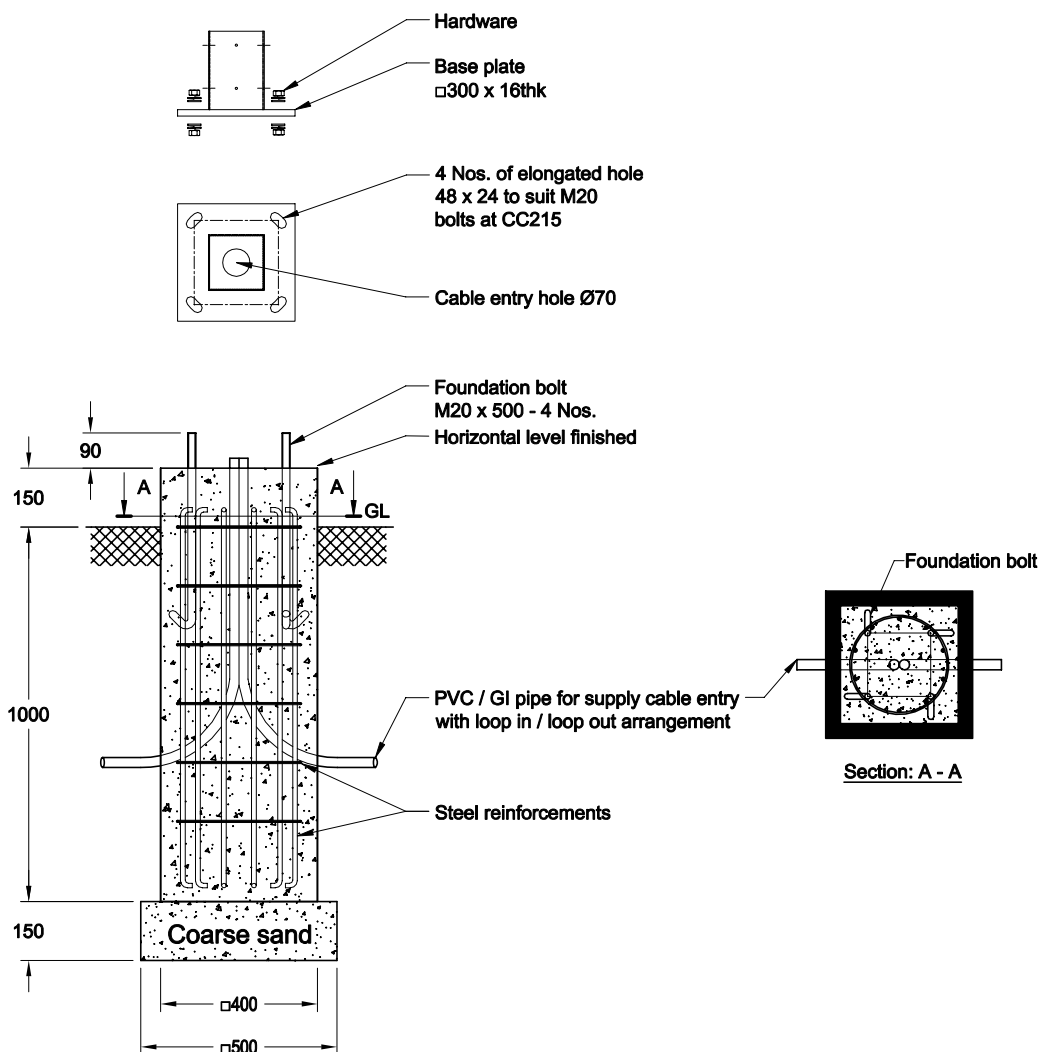

#### Note

- Typical foundation drawing for standard soil condition.
- Parameters considered in RCC foundation design :
  - Load bearing capacity of soil (LBC) : 10 Mt/m<sup>2</sup> (Minimum)
  - Basic wind speed : 50 m/s
  - Grade of steel reinforcement : Fe 415
  - Grade of foundation bolt : 4.6
- Height of foundation above ground level (150mm) may be revised to suit the site conditions especially considering the expected water level stagnation.
- Template supplied is suggested to be used for locating the CC of foundation bolts.
- 4 Nos. of foundation bolt have to be oriented (located), while casting the foundation such that the door of the electrical junction box faces the required direction.
- PVC / GI pipe for entry of supply cable and the materials required for foundation are not scope of our supply.

REV. No.	REVISION DETAILS	DATE	REVISED	CHD	APPD
----------	------------------	------	---------	-----	------

DRAWN ABISHEK	CHECKED	APPROVED	DATE 08-09-20	SCALE 1 : 20	MATERIAL -	Z:\K - LITE\006.FOUNDATION DETAILS\KL - DFD - 103 (M48)\KL - DFD - 103 (M48),REV00.dwg
<b>K-LITE</b> <b>K-LITE INDUSTRIES</b> CHENNAI-600 058						DETAILED FOUNDATION DRAWING M48 □300 x 16 (FOUNDATION BOLT M20 x 500)
			DRG. NO. <b>KL-DFD-103</b>		REV 00	SHEET 1 of 1

1

2

3

4