

1

2 IF IN DOUBT ASK. DO NOT SCALE.

3

4

DWG. No. : KL-DFD-093
SHEET No. : 1 of 1

ALL DIMENSIONS ARE IN mm

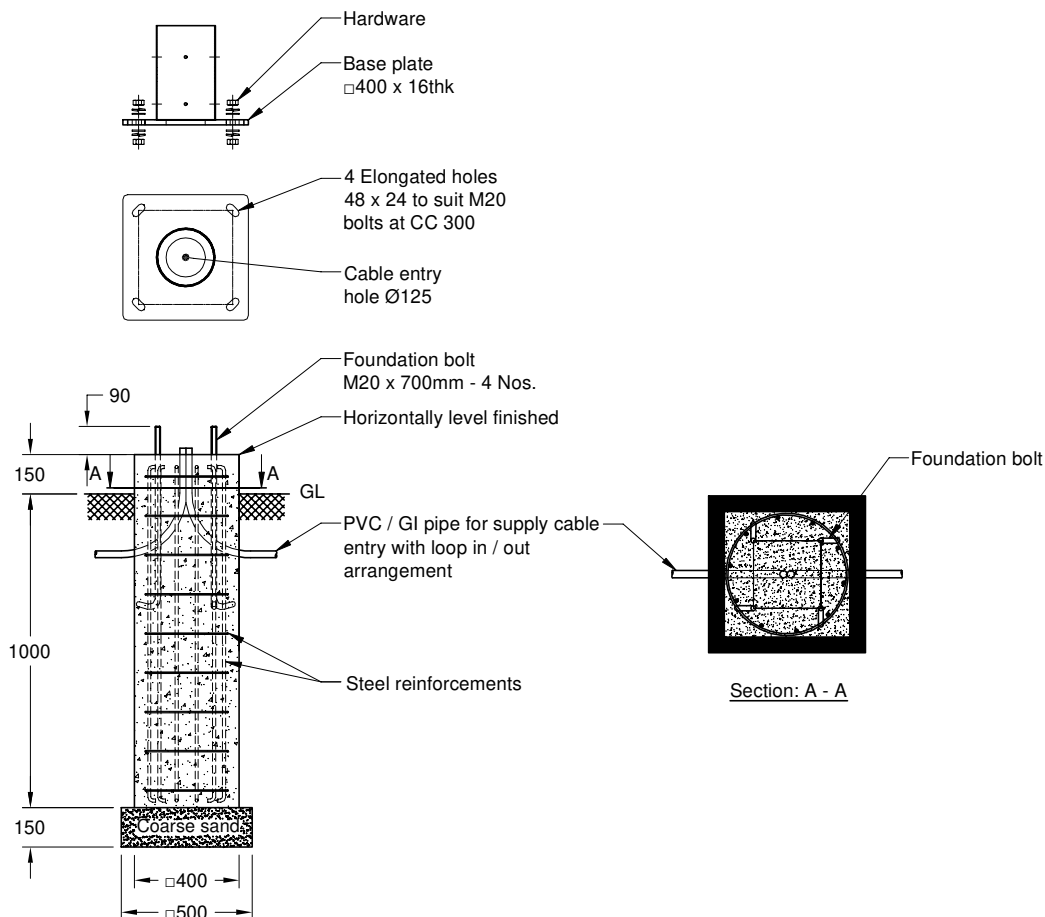
**Note :**

- Typical foundation drawing for standard soil condition.
- Parameters considered in RCC foundation design :
Load bearing capacity of soil (LBC) : 10 Mt/m² (Minimum)
Basic wind speed : 50 m/s
Grade of steel reinforcement : Fe 415
Grade of foundation bolt : 4.6
- Height of foundation above ground level (150mm) may be revised to suit the site conditions especially considering the expected water level stagnation.
- Template supplied is suggested to be used for locating the CC of foundation bolts.
- 4 Nos. of foundation bolt have to be oriented (located), while casting the foundation such that the door of the electrical junction box face the required direction.
- PVC / GI pipe for entry of supply cable and the materials required for foundation are not scope of our supply.

01	BASE PLATE DESING CHANGED	08-09-20	ABISHEK		
REV. No.	REVISION DETAILS	DATE	REVISED	CHD	APPD

DRAWN THIRUPATHI	CHECKED	APPROVED	DATE 12-06-19	SCALE 1:25	MATERIAL -	Z:\K - LITE\006.FOUNDATION DETAILS\KL - DFD - 093 (M43)\REV 01.DWG			
K-LITE		K-LITE INDUSTRIES CHENNAI-600 058				DETAILED FOUNDATION DRAWING FOR M43 □400 x 16 (FOUNDATION BOLT M20 x 700)			
				DRG. NO. KL-DFD-093		REV 01	SHEET 1 of 1		