

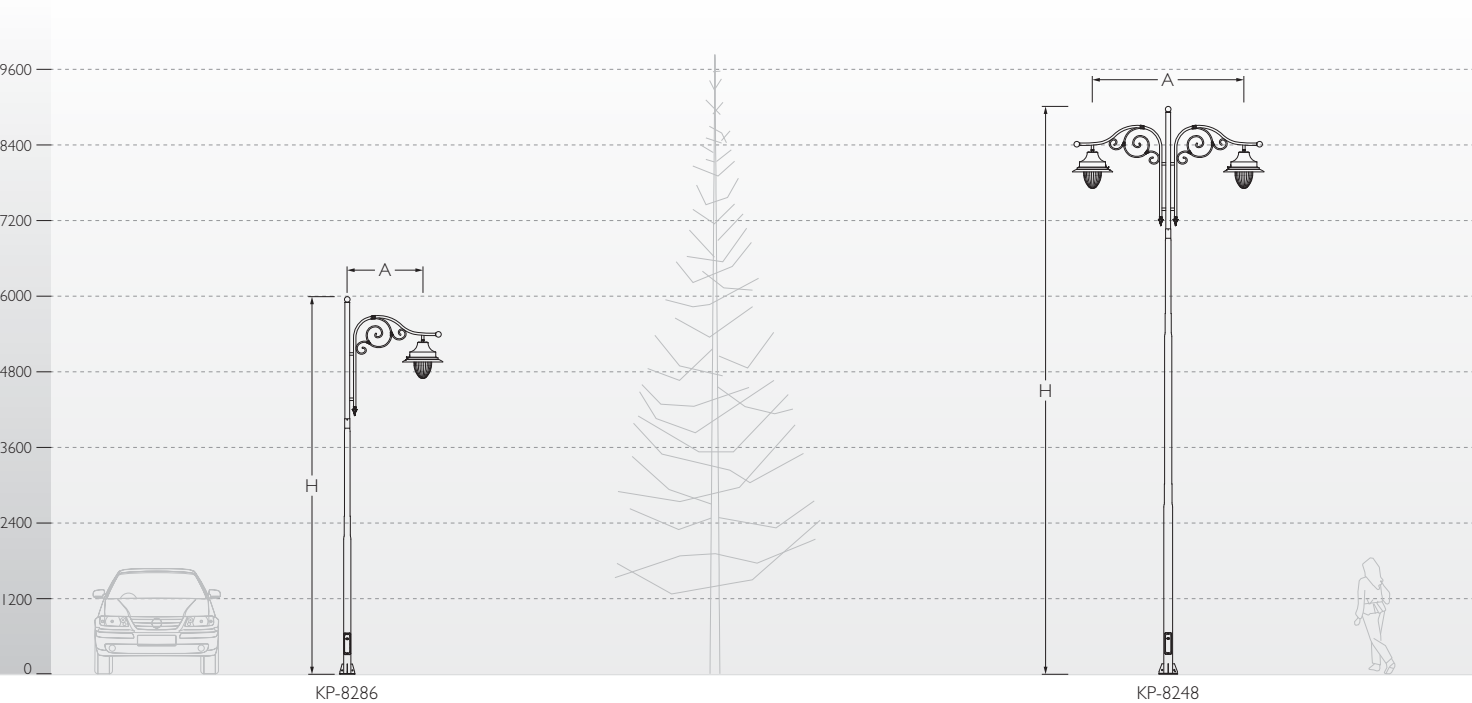

ID	Arm	A	H
KP-8286	Single	1200	6000
KP-8287	Double	2400	6000
KP-8247	Single	1200	9000
KP-8248	Double	2400	9000

Swaged Pole



Elegance is an architecturally designed solution which is discreetly fused with modernity. This pole offers a solution to the cities which are adopting modernity but also preserving their heritage values.

Features:

- Elegance pole with single / double arm is designed for street lighting, suitable for various pendant type street light luminaires.
- This architecturally designed pole is structurally sound. Pole design parameters vary depending on the type of bracket and loading factor.
- Pole sections are swaged and joint together using special v groove technique by certified welders using high end MIG welding processes.
- Built-in control box with cast aluminium service door and safety rope.
- The control gear tray is prewired with MCB, terminal connectors for loop-in loop-out arrangement.
- CE - Conformity mark

Fixture Options



Finish : Coated with epoxy zinc phosphate primer and finished using environmentally stable polyurethane based paint.

Applications : Various luminaire options make it suitable for main / secondary roads and streets, boulevards and public places.

Installation : Surface mounted with base plate and fitted on a pre formed foundation.

Mounting Details

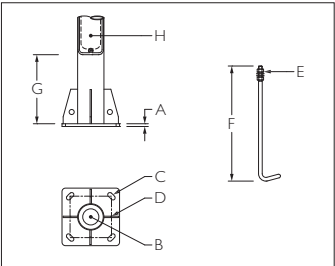

Pole Height	Base plate (A)	Cable Entry Hole (B)	No.of holes/ bolts (C)	CC (D)	Bolt (E)	Length (F)	Junction box from base plate (G)	Electrical junction box (H)
5000	□250 x 12thk	Ø70	4	180	M16	500	300	295 x 85
6000	□250 x 12thk	Ø70	4	180	M16	500	300	295 x 85
7000	□300 x 16thk	Ø70	4	215	M20	500	300	295 x 85
8000	□300 x 16thk	Ø70	4	215	M20	500	300	295 x 85
9000	□300 x 16thk	Ø70	4	215	M20	500	300	295 x 85
10000	□400 x 16thk	Ø125	4	300	M20	700	300	295 x 85
11000	□400 x 16thk	Ø125	4	300	M20	700	300	295 x 85
12000	□400 x 16thk	Ø125	4	300	M24	1000	300	295 x 85

