

1

2 IF IN DOUBT ASK. DO NOT SCALE.

3

4

DWG. No. : KP-DFD-089  
SHEET No. : 1 of 1

ALL DIMENSIONS ARE IN mm

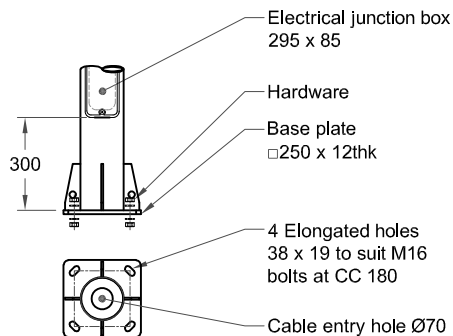

FOUNDATION TYPE	POLE HEIGHT	DIMENSION "X"
A	5m	800
B	7m	1000

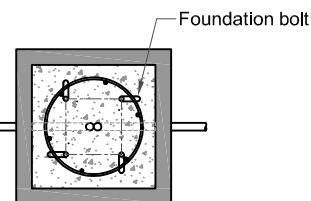
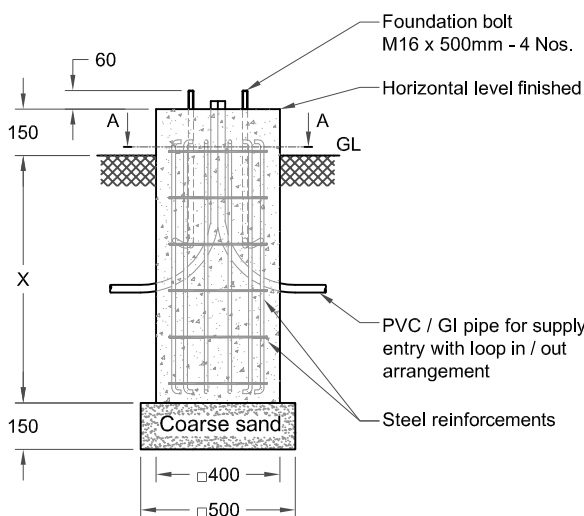

Section: A - A

**Note :**

- Typical foundation drawing for standard soil condition.
- Parameters considered in RCC foundation design :  
 Load bearing capacity of soil (LBC) : 10 Mt/m<sup>2</sup> (Minimum)  
 Basic wind speed : 50 m/s  
 Grade of steel reinforcement : Fe 415  
 Grade of foundation bolt : 4.6
- Height of foundation above ground level (150mm) may be revised to suit the site conditions especially considering the expected water level stagnation.
- Template supplied is suggested to be used for locating the CC of foundation bolts.
- 4 Nos. of foundation bolt have to be oriented (located), while casting the foundation such that the door of the electrical junction box faces the required direction.
- PVC / GI pipe for entry of supply cable and the materials required for foundation are not scope of our supply.

REV. No.	REVISION DETAILS	DATE	REVISED	CHD	APPD
----------	------------------	------	---------	-----	------

DRAWN R.SATHISH	CHECKED	APPROVED	DATE 19-03-18	SCALE 1 : 25	MATERIAL -
--------------------	---------	----------	------------------	-----------------	---------------

Z:\KP\005.FOUNDATION DETAILS\KP - DFD - 089\REV 00.dwg

**K-LITE INDUSTRIES**

CHENNAI - 600 058

DETAILED FOUNDATION DRAWING FOR KP - 43  
□250 x 12 (FOUNDATION BOLT M16 x 500)

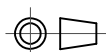

DRG. NO.

KP-DFD-089

REV  
00SHEET  
1 of 1

1

2

3

4